

INSTALLATION INSTRUCTIONS

LED60-SET / LED60-SET-M LED Conversion Kit

PACKAGE:

LED60-SET (for DSZ-44 / NSW)

- a) LED Ring Light with cable – 1 pce.
- b) Control Box (power supply) – 1 pce.
- c) Ring Adapter – 1 pce
- d) Fixing Screws (A) for ring adapter – 4 pcs.
- e) Fixing Screws (B) for LED Ring Light – 3 pcs.

LED60-SET-M (for SPZ-50)

- Same as left, but
- f) Fixing Screws with standoffs (C) – 4 pcs instead of d)

1. Detach a F. Lamp Shade from microscope stand by unscrewing 4 screws.

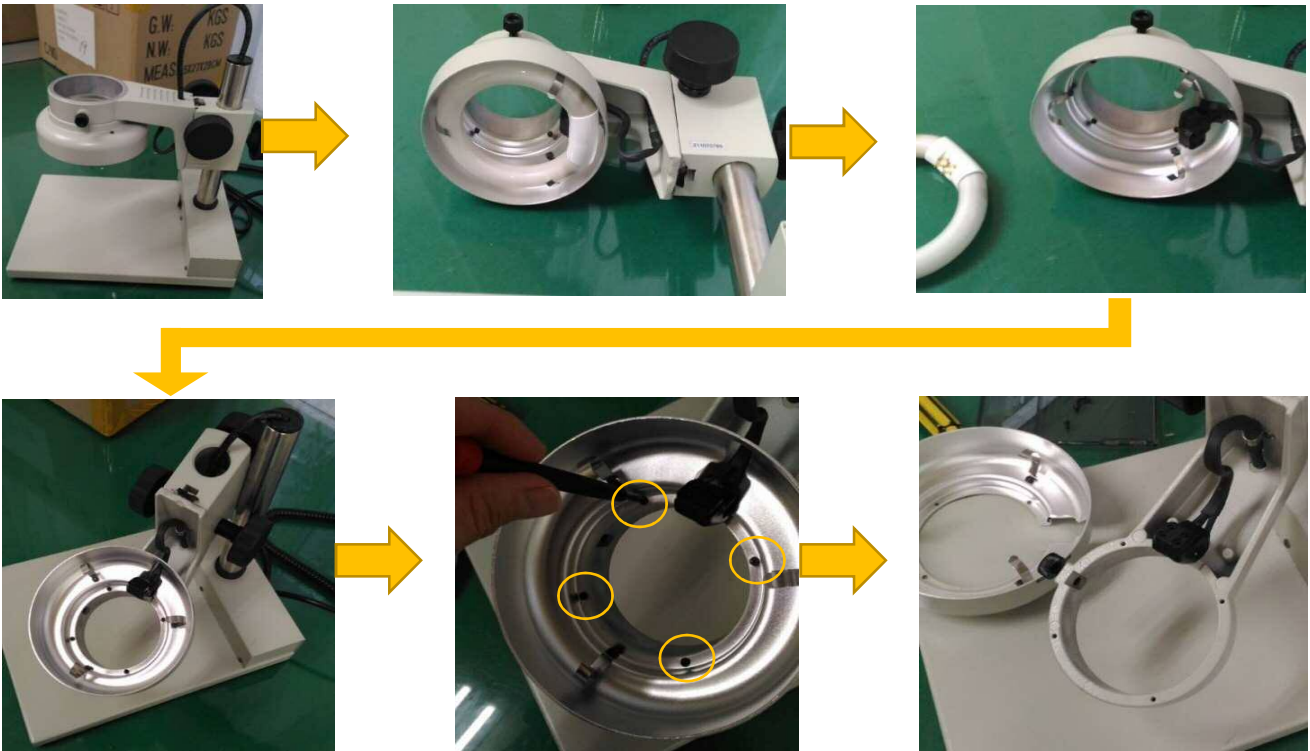

2. LED60-SET: Attach a Ring Adapter with 4 Fixing Screws (A)

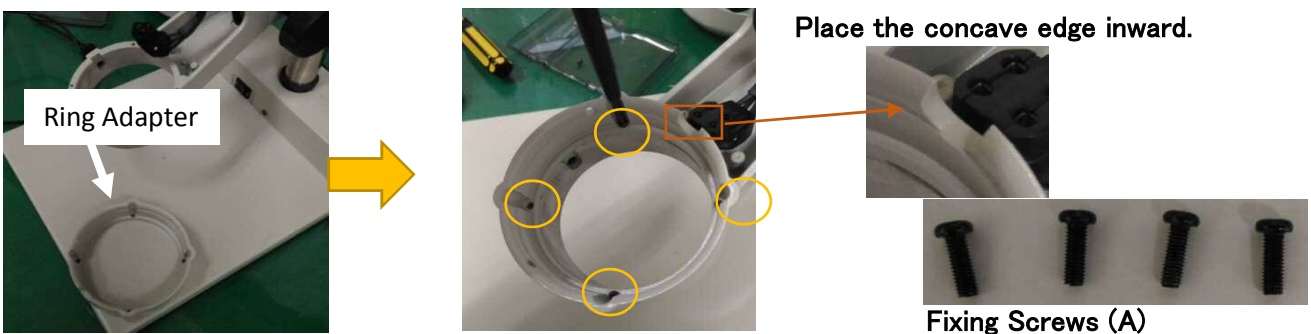

3. LED60-SET: Attach a LED Ring Light with 3 Fixing Screws (B)



Fixing Screws (B)

2" & 3". LED60-SET-M: Attach a Ring Adapter with 4 Fixing Screws and Standoffs (C) and attach a LED Ring Light with 3 Fixing Screws (B).

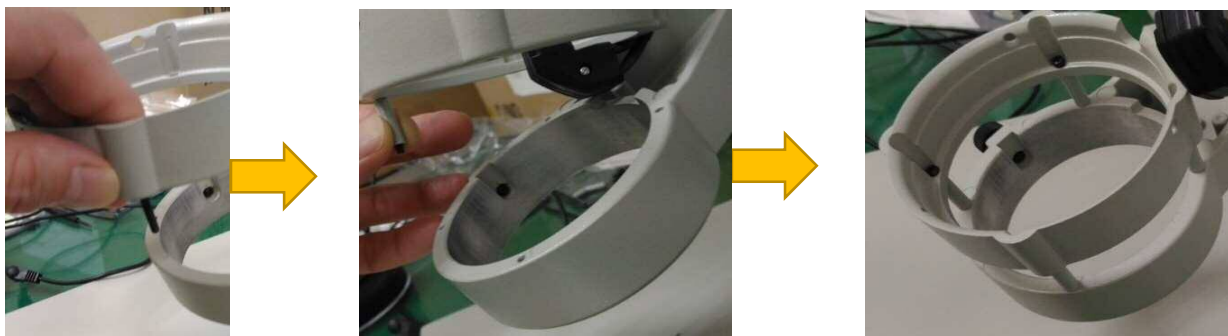

Fixing Screw and Standoff (C)